

DELTA[®] protects property. Saves energy. Creates comfort.



DELTA[®] -MAXX TITAN Thermomembrane

PREMIUM QUALITY

Warm in winter! Cool in summer!

- Reduces heat-energy consumption by up to 9%.
- Reflects radiant heat up to 50%.
- Ensures a comfortable climate under the roof at all times.
- Highest quality reflective roof underlayment.
- Adds value to your home.



■ Vapor permeable roofing membrane

■ For fully insulated pitched roofs and facades

■ New construction and re-roofing

**A perfect solution
all year round?
DELTA® System – Always
the right choice!**



**■ Outside (summer):
DELTA®-MAXX TITAN**
When temperatures are high, attics may grow uncomfortably hot very quickly as the heat protection afforded by conventional building products is often inadequate. DELTA®-MAXX TITAN reflects radiant heat, keeping the interior comfortably cool and markedly improving living quality.

**■ Outside (winter):
DELTA®-MAXX TITAN**
The adhesive overlaps of DELTA®-MAXX TITAN act like the overlapping zipper of a wind breaker, putting an end to the considerable loss of energy caused by cold outside air flowing into the interior.

**■ Inside:
DELTA®-REFLEX**
Vapor barrier sheet. Provides 10% increase in thermal insulation, 50% heat reflection, 100% barrier against air and vapor.

Don't allow heat to get under the roof in the first place:

DELTA®-MAXX TITAN

Breathable Thermomembrane. Re...

DELTA®-MAXX TITAN for fully insulated roofs, with or without sheathing.

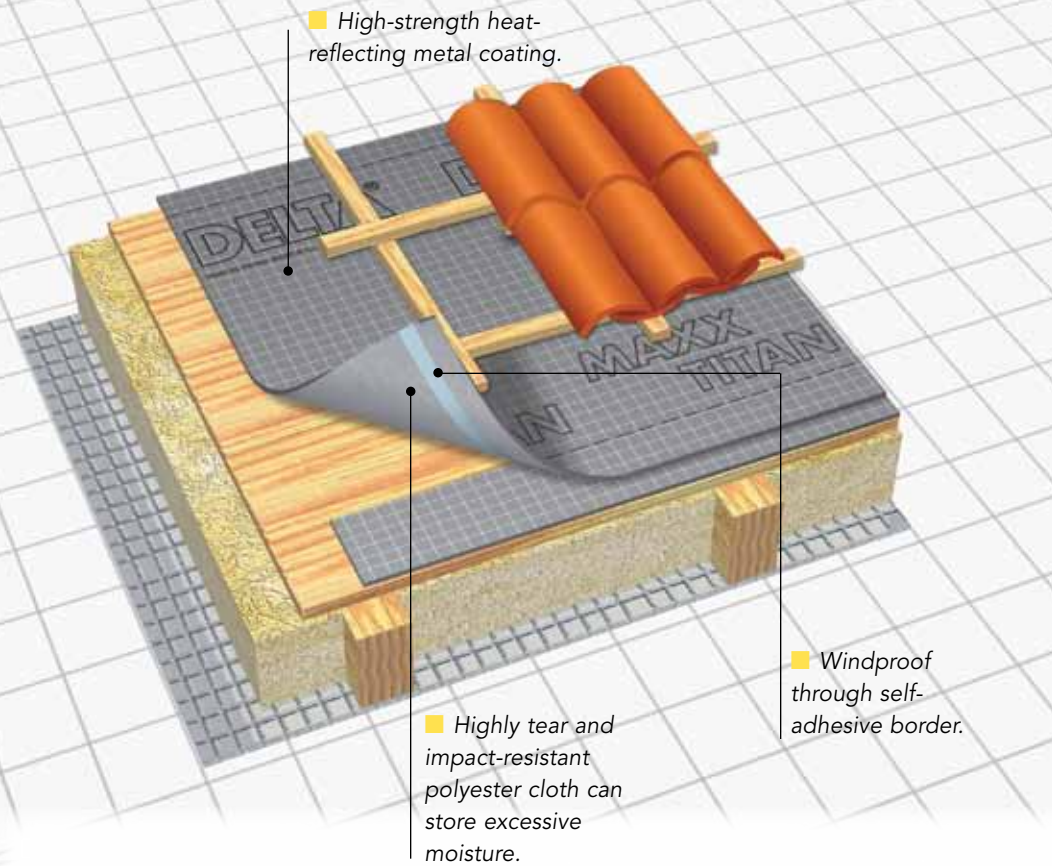

DELTA®-MAXX TITAN for outer-wall insulation.

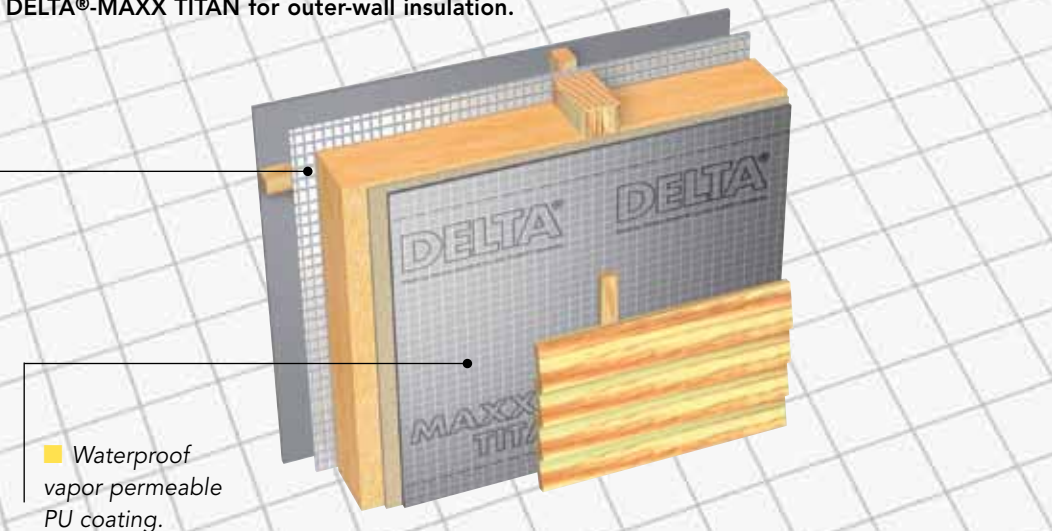

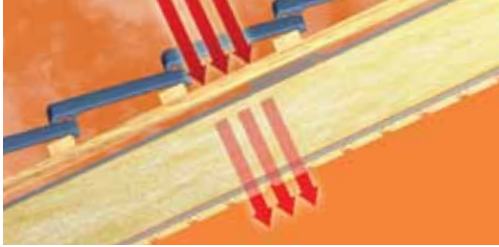

Without protection, heat will penetrate underneath the roof.

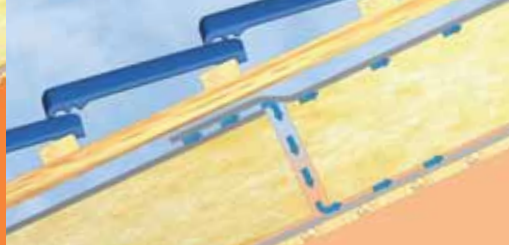

Without proper seals, cold air will penetrate into the attic.



DELTA®-MAXX TITAN: Complete climate control.

duces heat-energy consumption by up to 9%.

DELTA®-MAXX TITAN ...

- ... is a breathable, water and wind-proof thermomembrane offering heat protection all year round.
- ... lowers air exchange rates and, consequently, heat-energy consumption by up to 30% and 9%, respectively.
- ... reflects up to 50% radiant heat.
- ... may lower attic temperatures on a hot day by as much as 3°F (2°C) compared to buildings equipped with conventional, non-reflecting base sheets*.
- ... is based on DELTA®-MAXX with a proven record of reliability over more than 20 years.
- ... features a moisture-storage layer: In extreme situations, the underside of the thermomembrane may absorb up to 3 oz per ft² (1 litre/m²), to be gradually released outward through evaporation.
- ... is very vapor permeable, allowing moisture from the interior to safely escape to the outside.
- ... provides extremely high tear strength, making the product very safe to work with on the roof.

* Actual temperature reduction depends, among other conditions, on the room volume, the inclination of the roof, the roofing material, the orientation of the building, the size of the windows, and the thickness of the insulation material.

Evaluation Report (Certification)
ICC-ESR2625



DELTA®-MAXX TITAN offers year-round heat protection and lowers the air exchange rate.

Profit from the DELTA® System!

Outside ...

... year-round heat protection by DELTA®-MAXX TITAN, our breathable, highly tear-resistant thermomembrane which ensures a markedly improved living climate thanks to its outstanding advantages over conventional roofing products.

Inside...

... DELTA®-REFLEX air and vapor barrier. An energy-saving sheet made of rugged, highly flexible 4-ply material. Reflects heat and saves on heating costs. Provides protection from electrical smog.



Needless to say, we have a range of perfect accessories, which you can find additional information about on the next page.

DELTA®-MAXX TITAN

Technical Data (typical values):

Material	Highly tear-resistant polyester fabric with a vapor permeable polyurethane coating, a heat-reflecting surface, and a self-sealing edge.
Application	For fully insulated pitched roofs and outer-wall protection.
Fire resistance	Class E (EN 13501-1)
ASTM E96 (Proc. B)	
Water Vapor Transmission (g/m ² 24h)	196.3
Permeance (ng/Pa/s/m ²)	1620
Perms (grains/h ² /in Hg)	28.3
ASTM D5035	
MD: Breaking Load	100.6 lb/2 in. (447.5 N/50mm)
MD: Elongation at break	55.1 %
CD: Breaking Load	60.2 lb/2 in. (267.7 N/50mm)
CD: Elongation at break	93.6 %
ASTM D1922 - 03a	
MD: Tear resistance	5640 g
CD: Tear resistance	7604 g
ASTM D4533 - 2004	
MD: Tearing Strength	58.3 lb (259.3 N)
CD: Tearing Strength	42.1 lb (187.3 N)
ASTM D751 (sections 33-36)	
MD: Tearing Strength	N.M.
CD: Tearing Strength	110.6 N
AATCC Test Method 42-2000	
Water impact resistance	pass
CAN/CGSB-4.2 No 26.3 - 95/ISO	
Resistance to water penetration	775.8 cm
ASTM D3462-03 section 8.1.11	
Pull-Through Force	231.7 N
ASTM C1371-04a	
Emmittance	0.40
ASTM C1549-04	
Reflectance	48.9%
Service temperature range	-40°F to 176°F (-40°C to +80°C)
Weight	approx. 5.3 oz/yd ² (180 g/m ²)
Roll weight	approx. 29 lbs. (13 kg)
Roll size	164' x 4.92' (50 m x 1.50 m)

Due to variable weather and UV conditions, we recommend efficient covering of the roof underlayments.

DELTA®-Accessories for DELTA®-MAXX TITAN.

DELTA® System makes life easier with these accessories.



DELTA®-MULTI-BAND

All-round adhesive tape featuring top adhesion. For all DELTA® sheets for interior and exterior application, particularly for sealing overlaps and openings and repairing tears.



DELTA®-THAN

Permanently elastic sealing compound for fixing and seam jointing of DELTA® sheet products. Can also be used to secure connections.



DELTA®-FLEXX-BAND

Stretchable sealing tape for inner and outer connections to structural details such as skylights, dormer windows, exhaust pipes, cables etc.



DELTA®

... for owners:

"... What I get is a mature problem solution provided at a fair price by the top specialist in quality branded products!"

... for workers:

"... What I get is a complete system made by a single manufacturer that enables me to do anything to the owner's entire satisfaction. There is no safer way!"

... for planners:

"... I can be certain that both innovative and standard products will be used in implementing my roof and cellar plans in a systematic and forward-looking way."

The information printed in this brochure reflects product information and specifications at the date of printing. The manufacturer reserves the right to make changes when necessary.

■ Detailed installation instructions for all DELTA® products may be obtained from cosella-dorken.com as PDF files for you to print out and save.

DELTA® stands for quality products that you can trust - manufactured in-house by Dörken.

COSELLA DÖRKEN
 Cosella-Dörken Products Inc.
 4655 Delta Way
 Beamsville, Ontario
 LOR 1B4
 (905) 563-3255
 Fax: (905) 563-5582
 1-888-4 DELTA 4
 info@cosella-dorken.com
 delta-maxxtitan.com
A company of the Dörken Group