

This technical data sheet is based upon the CSC Manu-Data® format.

December 21, 2011

## 1. Product Name

DELTA®-FASSADE S and  
DELTA®-FASSADE S PLUS UV  
resistant Water-resistive Barriers.

## 2. Manufacturer

Cosella-Dörken Products Inc.  
4655 Delta Way  
Beamsville, Ontario, L0R 1B4  
Canada  
Phone: 1-(905)-563-3255  
Toll Free: 1-(888)-433-5824  
e-mail: [info@cosella-dorken.com](mailto:info@cosella-dorken.com)  
URL: <http://cosella-dorken.com>

## 3. Product Description

### DESCRIPTION

DELTA®-FASSADE S and  
DELTA®-FASSADE S PLUS  
consist of a layer of non-woven,  
thermo-bonded polyester coated on  
one side with an acrylic coating.  
The DELTA®-FASSADE S PLUS  
product has a factory applied self  
adhesive strip on the front side of  
the top edge and the back side of the  
bottom edge for sealing the long  
edges of the water-resistive barrier.

### BASIC USE

DELTA®-FASSADE S and  
DELTA®-FASSADE S PLUS  
Water-resistive Barriers are used as  
an essential part of moisture  
management for building enclosures  
when using an open joint cladding  
system. Their vapor permeability  
allows the building enclosure to dry,  
while water passing through the  
exterior cladding cannot migrate  
past the membrane due to the water  
penetration resistance. Their UV  
resistance provides a long life to the  
water-resistive barrier.

### BENEFITS

Vapor permeable water-resistive  
barrier has highly tear-resistant  
polyester substrate with a special

waterproof polymeric coating which  
is designed for use as a water-  
resistive barrier in an open joint  
wall cladding system. It will resist  
the passage of bulk water and wind-  
driven rain while remaining highly  
water vapor permeable and stable in  
UV light. DELTA®- FASSADE S  
and DELTA®-FASSADE S PLUS  
will act as a drainage plane to  
channel water to the outside of the  
building and help protect the  
structure from the damaging effects  
of moisture infiltration and ultra-  
violet light.

### LIMITATIONS

Do not use DELTA®-FASSADE S  
or DELTA®-FASSADE S PLUS  
water-resistive barriers on cladding  
systems that have open joints  
greater than 2" wide or show more  
than 40 % of the entire facade  
surface.

### Figure 1 - DELTA®-FASSADE S and -FASSADE S PLUS

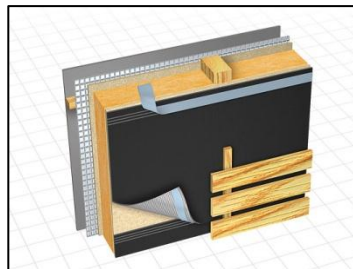

### TYPES AND SIZES

DELTA®-FASSADE S is  
available in rolls 4'-11" wide and  
164' long.

DELTA®-FASSADE S PLUS is  
available in rolls 4'-11" wide and  
164' long and has a 2" self-adhesive  
strip along each edge. The adhesive  
is on the front side of the top edge  
and the back side of the bottom  
edge.

## 4. Technical Data

Copies of test procedures and results  
are available upon request.

### APPLICABLE STANDARDS

American Association of Textile  
Chemists and Colorists

- AATCC 42: Water Resistance:  
Impact Penetration Test.

ASTM International

- ASTM D882: Standard Test  
Method for Tensile Properties  
of Thin Plastic Sheeting.
- ASTM D1922: Standard Test  
Method for Propagation Tear  
Resistance of Plastic Film and  
Thin Sheeting by Pendulum  
Method.
- ASTM D3462: Standard  
Specification for Asphalt  
Shingles Made from Glass Felt  
and Surfaced with Mineral  
Granules.
- ASTM D4533: Standard Test  
Method for Trapezoid Tearing  
Strength of Geotextiles.
- ASTM D5035: Standard Test  
Method for Breaking Force and  
Elongation of Textile Fabrics  
(Strip Method).
- ASTM E84: Standard Test  
Method for Surface Burning  
Characteristics of Building  
Materials.
- ASTM E96/96M: Standard  
Test Methods for Water Vapor  
Transmission of Materials.
- ASTM E2178: Standard Test  
Method for Air Permeance of  
Building Materials.

International Code Council

ICC-AC 38 - Acceptance Criteria  
For Water-Resistive Barriers.

US Green Building Council

- USGBC: LEED® NC Version  
2.2.

### APPROVALS

International Code Council

- ICC-ESR 2932 - Evaluation  
Report.

## ENVIRONMENTAL CONSIDERATIONS

Do not install DELTA®-FASSADE S or DELTA®-FASSADE S PLUS Water-resistive Barriers during adverse weather conditions and when wind velocities may hamper application.

## SUSTAINABILITY CONSIDERATIONS

DELTA® products support sustainable and energy efficient building practices, including efforts toward achieving LEED® certification (LEED® for New Construction & Major Renovations, LEED® for Core and Shell, LEED® for Existing Buildings and LEED® for Homes).

## 5. Installation

Ensure the substrate is dry and free from dust and other deleterious materials before application.

Ensure water-resistive barrier is installed with textured side facing substrate.

Unroll water-resistive barrier with printed side out, wrapping entire building, including rough openings for windows and doors.

Start installation at building corner, leaving 6-12 inches of membrane extended beyond corner.

Install horizontally starting at bottom of wall and overlap subsequent sheets to shed water similar to a shingle application.

Seal all joints if additional air tightness is desired.

## 6. Availability and Costs

### AVAILABILITY

Order water-resistive barrier materials 2 – 4 weeks prior to required delivery dates.

### COSTS

Contact Cosella-Dörken Products Inc., for current product costs.

## 7. Warranty

Standard one year builder's warranty.

There is also a 10 year material warranty available.

## 8. Maintenance

There is no maintenance required for this product. A hand roller should be used for tapes and flashings.

## 9. Technical Services

Technical representative will visit project site as required during construction. Call 1-888-433-5824 x326 for technical assistance.

## 10. Filing Systems

- MasterFormat™ 07 28 00
- OmniClass™  
Table 21-02 20 10 80.  
Table 22-07 28 00.  
Table 23-13 25 26.