

DELTA® protects property. Saves energy. Creates comfort.

## TECHNICAL DATA SHEET

### DELTA®-THENE 60

**Self-adhering Waterproofing Membrane for Commercial Applications.**

#### MATERIAL

DELTA®-THENE 60 is a 60 mil (1.5 mm) thick self-adhering (peel & stick) waterproofing membrane. It consists of SBS (styrene-butadiene-styrene) modified asphalt laminated to a co-extruded high-density polyethylene film.

#### PROPERTIES

DELTA®-THENE 60 has highly aggressive adhesive properties. The product acts as a full coverage below grade waterproofing membrane. When used in combination with DELTA®-DRAIN, DELTA®-DRAIN 6200 or other DELTA® drainage composites, it provides a high degree of security and drainage for any commercial waterproofing application. DELTA®-THENE 60 has a positive edge bead for reliable adhesive-to-adhesive overlaps.

#### APPLICATION

DELTA®-THENE 60 comes in manageable 36" (92 cm) rolls with a release liner for easy application. It is applied below grade to provide an effective waterproofing barrier. DELTA®-THENE 60 is pre-printed with a dotted 2 1/2" (6.35 cm) lap line for easy overlaps and a 4" (10 cm) grid for convenient measuring and cutting. DELTA® Accessories complete a DELTA®-THENE 60 installation.

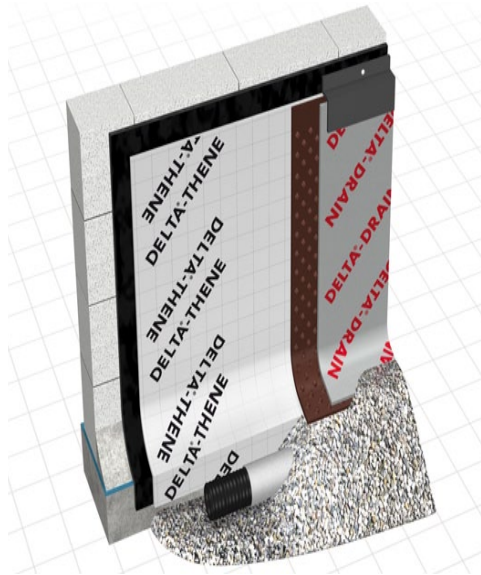

DELTA® products support sustainable and energy-efficient building practices, including efforts toward achieving LEED® certification (LEED® for New Construction & Major Renovations, LEED® for Core and Shell, LEED® for Existing Buildings and LEED® for Homes).

For technical support, call our technical support team at 1-888-4DELTA4 (1-888-433-5824) extension 326, or visit [www.cosella-dorken.com](http://www.cosella-dorken.com).

## Technical Data

Product name	DELTA®-THENE 60	
Color	White	
Top surface	High-density polyethylene	
Adhesive	SBS modified asphalt	
Thickness	approx. 1.5 mm (60 mils)	
Elongation	300%	ASTM D412
Tensile strength (membrane)	2.24 MPa minimum	ASTM D412
Tensile strength (film)	34.5 MPa minimum	ASTM D882
Minimum puncture resistance (membrane)	222 N	ASTM E154
Hydrostatic head	70 m of water	ASTM D5385
Crack cycling @ -32°C	Unaffected	ASTM D836
Water vapor transmission	1.6 ng/Pa s m <sup>2</sup> (0.03 perms)	ASTM E96
Lap peel strength @ 5°C	880 N/m width	ASTM D1876
Moisture absorption	0.2% maximum	ASTM D570-81
Temperature range	-40°C (-40°F) to +70°C (+158°F)	
Working temperature	+5°C (+41°F) to +30°C (+86°F) (air and sub-surface)	
Flexibility @ -40°C	Pass	ASTM D1970
Weight	29 kg (63 lb)	
Gross / net coverage per roll	18.7 m <sup>2</sup> / 17.3 m <sup>2</sup> (200 ft <sup>2</sup> / 186 ft <sup>2</sup> )	
Storage	Transport and store upright on pallet	
Dimension	18.6 m x 0.9 m (66' 7" x 3')	
Packaging	Shrink-wrapped roll	
Service life expectancy	> 25 years (at pH between 4 and 9 and temperature below 77°F / 25°C). Do not expose to UV light for more than 30 days.	
DELTA® Accessories	DELTA®-PRIMER (water-based) DELTA®-ADHESIVE (solvent-based) DELTA®-FLEXX-BAND DELTA®-SEALANT	